

UTILITY FRAME FOR TAPE AND SPACKLE

The TBF22 Utility Frames allow surface mount installation of ceiling diffusers in hard ceilings for tape and spackle applications to conceal the face of the frame.

Screw fastening provides a secure installation to the ceiling. Diffusers or other devices may require independent support.

The standard 24"x24" frame will accept 23 3/4" lay-in diffusers. Other made-to-order square or rectangular sizes from 6" to 72" are available.

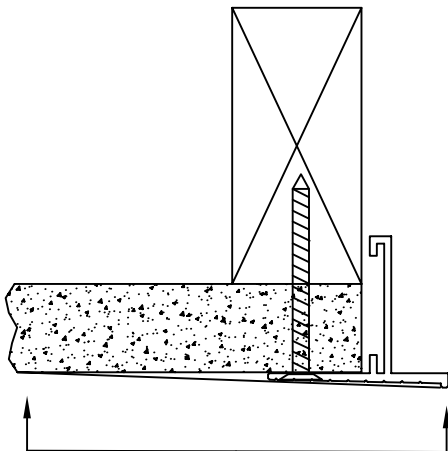

TAPE AND SPACKLE BY OTHERS

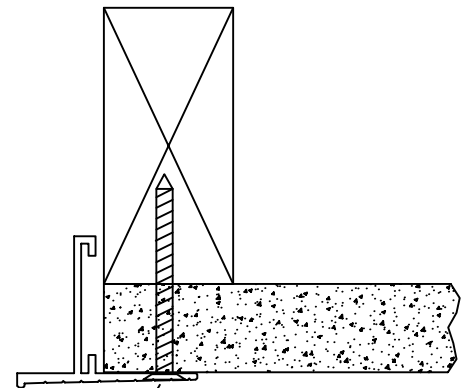

SCREW HOLES (STANDARD)

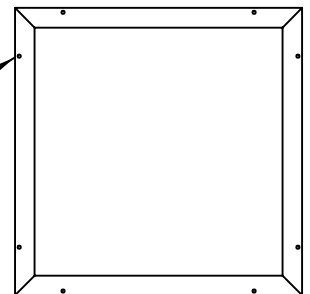

FEATURES

- EXTRUDED ALUMINUM CONSTRUCTION WITH MECHANICALLY FASTENED MITERED CORNERS.
- WHITE FINISH STANDARD.
- COUNTERSUNK SCREW HOLES IN THE FACE ARE STANDARD.
- OPTIONAL HARD CLIPS ARE AVAILABLE FOR PRE-MOUNTING BEFORE DRYWALL INSTALLATION.

OPTIONS

SIZE: _____
 (SPECIFY EXACT OVERALL DIMENSIONS OF THE DIFFUSER THAT THE FRAME MUST FIT.)

- HARD CLIPS FOR 1/2" THICK DRYWALL
- HARD CLIPS FOR 5/8" THICK DRYWALL

OPTIONAL HARD CLIPS FOR 5/8" OR 1/2" DRYWALL

ALLOWS PRE-MOUNTING TO FRAMING BEFORE DRYWALL

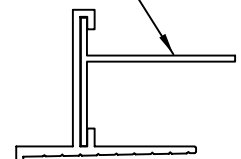

STANDARD INDUSTRY TOLERANCES APPLY. SPECIFICATIONS ARE SUBJECT TO CHANGE WITHOUT NOTICE.

JOB NAME: _____
 LOCATION: _____
 ARCHITECT: _____
 ENGINEER: _____
 CONTRACTOR: _____

MODEL TBF22 UTILITY FRAMES FOR TAPE & SPACKLE

DRAWN BY: RBJ DATE: 04-12-23 DWG. NO. TBF22