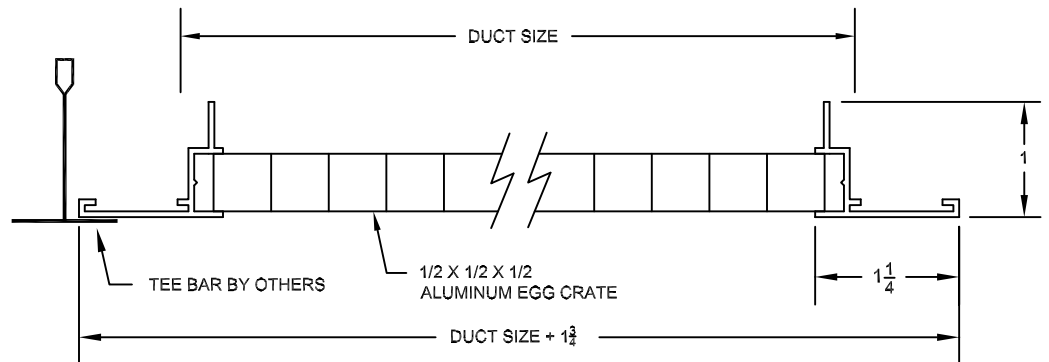
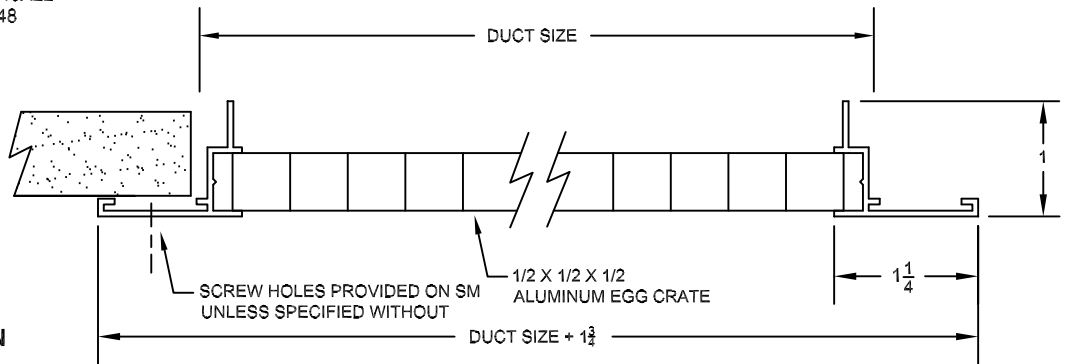

**STANDARD 1/2" THICK CORE**

**STANDARD TEE BAR LAY-IN**

MODEL ECR-TB  
 EX: ECR-TB-2222  
 (22 X 22 DUCT SIZE WITH 23.75 X 23.75 OVERALL FACE)

AVAILABLE DUCT SIZES FROM 22X10 TO 46X22  
 FOR CEILING TEE MODULES OF 12, 24 & 48

**SURFACE MOUNT APPLICATION**

MODEL ECR-SM  
 EX: ECR-SM-2424  
 (24 X 24 DUCT SIZE WITH 25.75 X 25.75 OVERALL FACE)

AVAILABLE DUCT SIZES FROM 6X6 TO 48X12

**FEATURES**

- ALUMINUM CONSTRUCTION
- STANDARD COLOR IS DONCO #26 WHITE. CONTACT FACTORY FOR OTHER OPTIONS.
- AVAILABLE FOR STANDARD TEE BAR LAY-IN OR SURFACE MOUNT. CONTACT FACTORY FOR OTHER APPLICATIONS.
- OPPOSED BLADE DAMPERS ARE AVAILABLE.
- PLENUMS AND LIGHT SHIELDS ARE AVAILABLE.

**OPTIONS (SPECIFY)**

- ECR-TB TEE BAR LAY-IN
- ECR-SM SURFACE MOUNT W/SCREW HOLES
- ECR-C CORE ONLY FOR LAY-IN (NO FRAME)
- \_\_\_ SIZE (USE MODEL # EXAMPLES ABOVE)

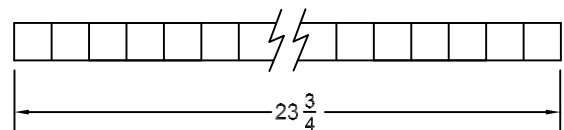
**CORE ONLY (NO FRAME)**

MODEL ECR-TB-C  
 EX: ECR-TB-C-2424 (23.75 X 23.75 OVERALL)  
 AVAILABLE SIZES: 2412, 2424 & 4824

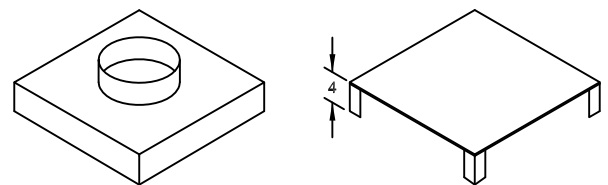
**PLENUM AND LIGHT SHIELD OPTIONS**

STANDARD INDUSTRY TOLERANCES APPLY. SPECIFICATIONS ARE SUBJECT TO CHANGE WITHOUT NOTICE.

JOB NAME: \_\_\_\_\_  
 LOCATION: \_\_\_\_\_  
 ARCHITECT: \_\_\_\_\_  
 ENGINEER: \_\_\_\_\_  
 CONTRACTOR: \_\_\_\_\_

## MODEL ECR-SM, ECR-TB

### EGG CRATE RETURN GRILLES

DRAWN BY: RBJ      DATE: 10-24-05      DWG. NO. ECR

**RAYMON** P.O. BOX 250 ALBION, IOWA 50005 www.raymon-hvac.com