

OPTIONAL INSULATION (SHOWN FOR REFERENCE ONLY)

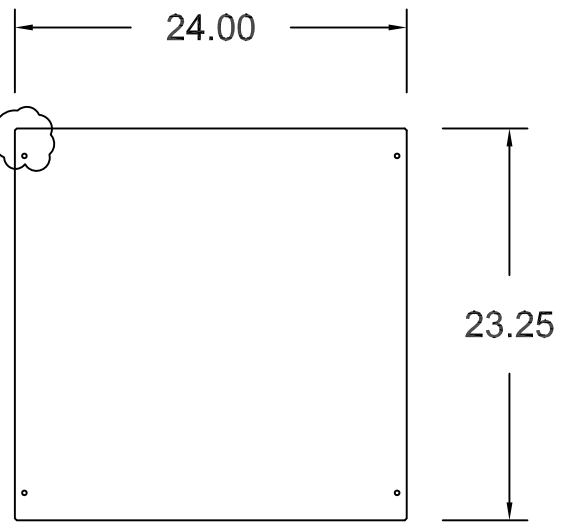

**OPITIONS (SPECIFY)**

- NON INSULATED CLS-N
- INSULATED CLS-L (1/2" FIBERGLASS W/BLACK FACING)

STANDARD INDUSTRY TOLERANCES APPLY. SPECIFICATIONS ARE SUBJECT TO CHANGE WITHOUT NOTICE.

**FEATURES**

- 22 GA. STEEL CONSTRUCTION, FACTORY CURVED
- INTERNAL SURFACES ARE FLAT BLACK

JOB NAME: \_\_\_\_\_  
 LOCATION: \_\_\_\_\_  
 ARCHITECT: \_\_\_\_\_  
 ENGINEER: \_\_\_\_\_  
 CONTRACTOR: \_\_\_\_\_

**MODELS CLS-N, CLS-L CURVED LIGHT SHIELDS**